

Type: mower
Specification: GK200;
Version: 2015-4
Page : 1/1

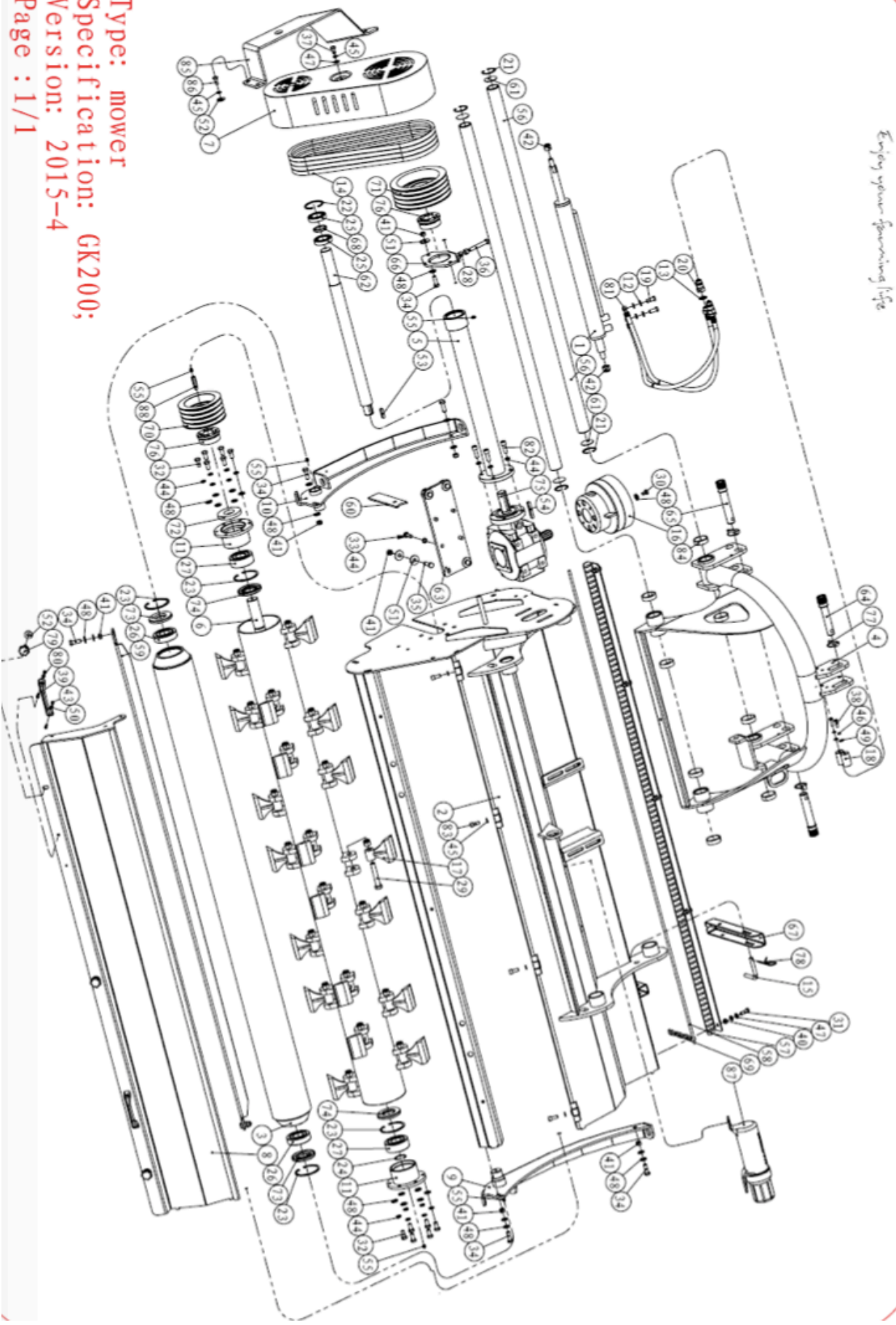

Item	Material code	Part No.	Description	Qty	U. WKg	GWT	Remark
1	11011000081	F. 2S/M165-104	Cylinder	1	8.57	8.57	
2	11000201252	GK200-011	Hood panel weldment	1	137.14	137.14	
3	11000201253	GK200-012	Roller weldment	1	60.61	60.61	
4	11000201254	GK200-013	Hitch weldment	1	43.82	43.82	
5	11000201255	GK200-014	The propeller shaft tube weldment	1	7.9	7.9	
6	11000201256	GK200-015	Blade axle welment	1	77.455	77.455	
7	11000201257	GK200-016	Belt cover weldment	1	5.39	5.39	
8	11000201258	GK200-017	Covering weldment	1	28.69	28.69	
9	11000201259	GK200-018	Skate weldment-L	1	7.22	7.22	
10	11000201260	GK200-019	Skate weldment-R	1	7.21	7.21	
11	11000201176	L. TRE220-015	Bearing seat weldment	2	1.67	3.34	
12	11011200000	BS/A13.70(G1/4)	Combined sealing gaskets (Automatic core)	4			
13	11011200003	BS/A21.50(G1/2)	Combined sealing gaskets (Automatic core)	2	0.001	0.002	
14	11011300024	BX1295.4	Belt	4			
15	11000100030	EF175.116	Kickstand pin	1	0.14	0.14	
16	11011800013	EF175.123	PTO dust cover	1	0.55	0.55	
17	11010200019	EFB175.139	Hammer blade	26	0.85	22.1	
18	11011800099	G. OS145-106	Adaptor holder	2	0.181	0.362	
19	11010600090	G1/4	Hollow bot	2	0.029	0.058	
20	11010900020	G1\2	Adaptor (male)	2	0.125	0.25	
21	14000400034	GB 893.1-86	Circlip 48	4	0.006	0.024	
22	14000400044	GB 893.1-86	Circlip 68	1	0.018	0.018	
23	14000400053	GB 893.1-86	Circlip 90	4	0.03	0.12	
24	14000300028	GB 894.2-86	Circlip 40	1		0	
25	11011500012	GB/T 276-94	Deep groove ball bearing 6008-RZ	2	0.177	0.354	
26	11011500044	GB/T 281-94	Self-aligning ball bearing 1308	2	0.725	1.45	
27	11011500046	GB/T 281-94	Self-aligning ball bearing 2308	2	0.944	1.888	
28	14050000004	GB/T 41-2000	Nut M12	2			
29	14010000024	GB/T 5782-2000	Bolt M16*95(Class 10.9)	26	0.189	4.914	
30	14010100037	GB/T 5783-2000	Bolt M10*16	2	0.021	0.042	
31	14010100040	GB/T 5783-2000	Bolt M10*30	5	0.03	0.15	
32	14010100065	GB/T 5783-2000	Bolt M12*25	12	0.039	0.468	
33	14010100067	GB/T 5783-2000	Bolt M12*30	4	0.043	0.172	
34	14010100069	GB/T 5783-2000	Bolt M12*35	8	0.047	0.376	
35	14010100071	GB/T 5783-2000	Bolt M12*40	4	0.052	0.208	
36	14010100079	GB/T 5783-2000	Bolt M12*80	1	0.088	0.088	
37	14010100038	GB/T 5783-2000	Bolt M10*20	1	0.023	0.023	
38	14010100019	GB/T 5783-2000	Bolt M8*25	2	0.016	0.032	
39	14060200014	GB/T 70.1-2000	HSKCS M6*20	4	0.008	0.032	
40	14050100003	GB/T 889.1-2000	Locknut M10	5	0.009	0.045	
41	14050100006	GB/T 889.1-2000	Locknut M12	12	0.013	0.156	
42	14050100008	GB/T 889.1-2000	Locknut M16	28	0.039	1.092	
43	14050100001	GB/T 889.1-2000	Locknut M6	4	0.003	0.012	
44	14020000008	GB/T 93-1987	Spring washer 12	20	0.003	0.06	
45	14020000007	GB/T 93-1987	Spring washer 10	9	0.002	0.018	
46	14020000006	GB/T 93-1987	Spring washer 8	2	0.001	0.002	
47	14040000003	GB/T 95-2002	Plain washer 10×2	15	0.003	0.045	
48	14040000004	GB/T 95-2002	Plain washer12×2.5	28	0.006	0.168	
49	14040000002	GB/T 95-2002	Plain washer 8×1.6	2	0.002	0.004	
50	14040000001	GB/T 95-2002	Plain washer 6×1.6	4	0.001	0.004	

Item	Material code	Part No.	Description	Qty	U. WKg	GWT	Remark
51	14040100004	GB/T 96.2-2002	Larger plain washer 12×3	14	0.022	0.308	
52	14040100003	GB/T 96.2-2002	Larger plain washer 10×2.5	5	0.012	0.06	
53	14030000000	GB/T1096.1979	Flat key 10×40	1	0.024	0.024	
54	14030000001	GB/T1096.1979	Flat key 10×70	1	0.042	0.042	
55	14000200002	GB1152.89	Pressure lubricator M10*1.0	5	0.007	0.035	
56	11012600022	GK200-101	Guide rail	2	8.521	17.042	
57	11000000516	GK200-102	Chain mounting plate	1	4.253	4.253	
58	11000100545	GK200-103	Chain mounted axle	1	0.782	0.782	
59	11000000517	GK200-104	Mud scraper plate	1	7.809	7.809	
60	11000000519	GK200-107	Sealplate	1	0.44	0.44	
61	11000000520	GK200-108	End cover	4	0.028	0.112	
62	11000100546	GK200-109	Connecting shaft	1	1.04	1.04	
63	11000000521	GK200-110	Gearbox mounting plate	1	4.128	4.128	
64	11011700018	GK200-111	II Hitch Pin(Upper)	1	0.69	0.69	
65	11011700019	GK200-112	II Hitch Pin(lower)	2	0.868	1.736	
66	11000000518	GK200-105	Adjusting ring	1	0.813	0.813	
67	11000000465	L. TRE220-121	Kickstand tube	1	1.359	1.359	
68	11000000468	L. TRE220-122	Spacer	1	0.032	0.032	
69	11010500036	R. OS/J225-OS-126	Chain n6x20x28	90	0.13	11.7	
70	11011400042	SPB-167-4-80	Pulley	1	4.865	4.865	
71	11011400041	SPB-219-4-80	Pulley	1	8.355	8.355	
72	11011200032	TC40*90*12	Oil seal	1	0.019	0.019	
73	11011200041	TC45*90*10	Oil seal	2	0.036	0.072	
74	11011200044	TC50*90*10	Oil seal	2	0.033	0.066	
75	11010000002	XH50.300Z.01W	Gearbox	1	22.976	22.976	
76	11011900004	Z6-40*80	Swellable sleeve	2	0.822	1.644	
77	11011700014	Φ11*45	PTO pin	3	0.05	0.15	
78	11011700015	Φ4	Hair pin cotter	1	0.02	0.02	
79	11011800032	Φ40*M10*25	Knob	3	0.021	0.063	
80	11011800108	代号	Handle	2	0.042	0.084	
81	11010700196	G1/2(公制)	Long oil hose	2	0.107	0.214	
82	14060200052	GB/T 70.1-2000	HSHCS M12*35	4	0.051	0.204	
83	14060200036	GB/T 70.1-2000	HSHCS M10*25	4	0.029	0.116	
84	11011800107	48X15X3	Rider ring	8	0.049	0.392	
85	11000000526	GK200-113	Belt guard fender	1	5.032	5.032	
86	14010100039	GB/T 5783-2000	Bolt M10*25	4	0.026	0.104	
87	11011800038		Manual canister	1	0.234	0.234	
88	11000100598	GK200-114	Pressure lubricator connector	1	0.03	0.03	

Item	Material code	Part No.	Description	Qty	mark
1	14050100008	GB/T 889.1-2000	Locknut M16	24	Used in 180 Model
2	14010000024	GB/T 5782-2000	Hexagon bolt M16*95	24	
3	11010200018	EF175.123	Large Y type Blade	48	
4	11011300024	BX1295.4	Belt	4	
5	11000100500	EF175-102	Blade Spacer	48	
1	14050100008	GB/T 889.1-2000	Locknut M16	26	Used in 200 Model
2	14010000024	GB/T 5782-2000	Hexagon bolt M16*95	26	
3	11010200018	EF175.123	Large Y type Blade	48	
4	11011300024	BX1295.4	Belt	4	
5	11000100500	EF175-102	Blade Spacer	52	
1	14050100008	GB/T 889.1-2000	Locknut M16	28	Used in 220 Model
2	14010000024	GB/T 5782-2000	Hexagon bolt M16*95	28	
3	11010200018	EF175.123	Large Y type Blade	56	
4	11011300024	BX1295.4	Belt	4	
5	11000100500	EF175-102	Blade Spacer	56	
Item	Material code	Part No.	Description	Qty	mark
1	14050100008	GB/T 889.1-2000	Locknut M16	24	Used in 180 Model
2	11010200019	EFB175.139	Hammer blade	24	
3	14010000024	GB/T 5782-2000	Hexagon bolt M16*95	24	
4	11011300024	BX1295.4	Belt	4	
1	14050100008	GB/T 889.1-2000	Locknut M16	26	Used in 200 Model
2	11010200019	EFB175.139	Hammer blade	26	
3	14010000024	GB/T 5782-2000	Hexagon bolt M16*95	26	
4	11011300024	BX1295.4	Belt	4	
1	14050100008	GB/T 889.1-2000	Locknut M16	28	Used in 220 Model
2	11010200019	EFB175.139	Hammer blade	28	
3	14010000024	GB/T 5782-2000	Hexagon bolt M16*95	28	
4	11011300024	BX1295.4	Belt	4	